

EasyVu Table Location Solution

Call Systems Technology Ltd

EasyVu Table Location Solution



EasyVu

The new and exciting table location system

Can be a self-installed system, giving customers freedom to grow their businesses

Incredibly cost effective

Locates guests and tables on demand for faster food delivery

EasyVu can also be used as a pager system to call customers back to the counter

The system uses a NFC (Near Field Communications) tag allowing for 100% accuracy

EasyVu Table Location Solution

Deliver hot food hot, and cold food cold - don't keep your guests waiting

Locate where your guests are with 100% accuracy

Self-Installed - Easy to use
- Freedom to grow your business

Improve your guest experience - keep your guests coming back to your restaurant

Improve food runner productivity - stop the run around trying to find tables

Improve efficiency and shave minutes of time off food delivery - save time, save money

Less expensive than ANY high performing table location system on the market

System can be used for table location or a paging system (return to the counter)

EasyVu Value Propositions

Data Log capability to help analyze your service and drive your business

A huge range of 250mtr outdoors / 125mtr indoors

Capable of using multiple gateways to extend coverage

Table Tags sit on top of tables, allowing EasyVu to accurately locate your guest

We offer customized Table Tags with your branding

Map feature allows you to draw your own store location to assist food runners

#1 Product Quality and Customer Service

Why EasyVu?

Winner of the 2016 QSR
Magazine Applied Tech Award

Vuze is located in more than
2000 locations worldwide

Vuze is an industry pioneer that set the standards
for locating guest on the hospitality scene

EasyVu exist today because of our award-
winning Vuze Table Location System

We have listened to our customers, and
challenges to create an affordable
alternative to VUZE

EasyVu allows ALL customers
the opportunity to maximize
their guest experience

EasyVu Components

EasyVu Tablet Windows 10 2-in-1 Notebook / Tablet that will display locations

Guest Locator Locator / Pager given to the customer to carry to the table

Charger Stackable housing for Guest Locator

Table Tag Durable plastic adhesive card that sticks to the table, talks to Guest Locator

Gateway Brain hub that stores and transmits location information

Software Internal ingredients that runs the system

Table Tag Writer Optional to the customer. Programs all Table Tags

EasyVu Components

Tablet – Touch Screen PC



- RCA Cambio 2-in1 notebook / tablet
- Windows 10 / 10" display
- USB 3.0 port / Micro USB port
- Battery life up to 6 hours

Guest Tag



- Diameter: 105 mm
- Thickness: 15 mm
- Weight: 102g
- Battery: Lithium / 12-14 hours off charge
- Out of Range Notification
- Alert Type: Vibe / Flash / LED / Find

EasyVu Components

Table Tag



- Length: 54 mm
- Width: 85 mm
- Weight: 5g
- Durable Plastic (adhesive)

- Diameter: 105 mm
- Thickness: 20 mm
- Weight: 90g
- ***DIFFERENT CHARGER FROM "CHAR"!

Guest Tag
Chargers



EasyVu Components

Gateway



- Length: 4.5 inches (116mm)
- Width: 5.5 inches (140mm)
- Height: 1.4 inches (37mm)
- Weight: 185g
- Carrier Frequency: 420-470 MHz
- Range: Up to 250 meters

- Table Tag Writer is OPTIONAL
- All table tags will be programmed in production during system set up

Tag Reader



How does EasyVu work?

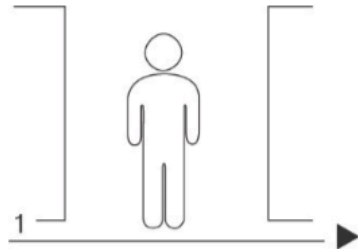

1
A customer enters & makes an order

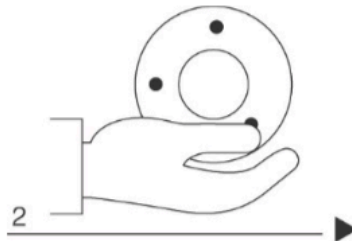

2
Gets a Guest locator



3
Takes a seat

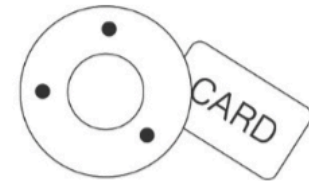

4
Guest locator + Table Tagging

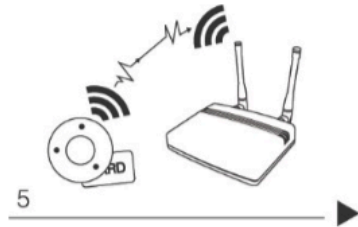

5
Receives the table info.
(Gateway)

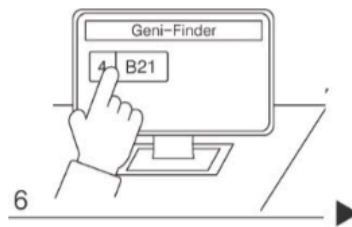

6
Display the table info.
(shows customer location)

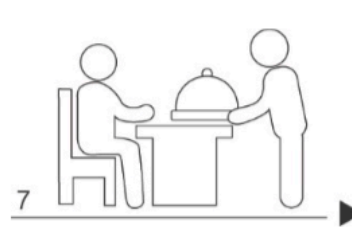

7
Food is served.

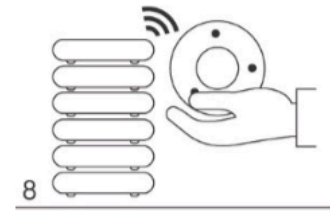

8
Guest locator is taken and placed back on the charger. (Reception cleared)

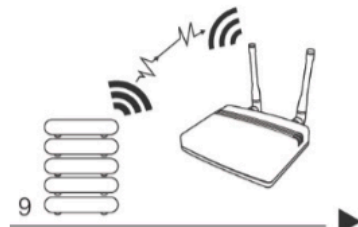

9
Reception cleared
(Gateway)

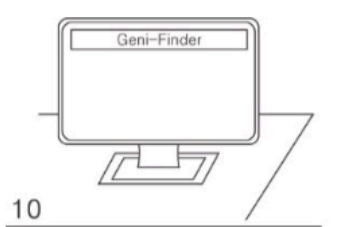

10
Table disappears – Service completed.

Table Location List

LEETEK - Geni Finder Client 6.3

ICON SET / MAP SET

SERVER IP ADDRESS 127.0.0.1 CONNECT Call Pager Call SEND SET CONFIG

02-13-2018 16:25:24 GUID

13	WAIT [00:02:24]	TABLE - 009	SEAT [00:02:08]	MAP
3	WAIT [00:02:24]	TABLE - 006	SEAT [00:02:14]	MAP
11	WAIT [00:02:24]	TABLE - 007	SEAT [00:02:14]	MAP
17	WAIT [00:02:24]	TABLE - 008	SEAT [00:02:11]	MAP
1	WAIT [00:02:04]	TABLE	SEAT [00:00:00]	MAP
20	WAIT [00:02:01]	TABLE - 010	SEAT [00:02:01]	MAP
6	WAIT [00:01:55]	TABLE	SEAT [00:00:00]	MAP

EasyVu simple logging on system

LEETEK - EasyVu Server 6.3

Server IP: 10.30.61.125 | COM-PORT: AUTO | STOP | Shop-Num: | SAVE | Gateway Read

GATEWAY

Base.ID	Gateway.ID	Type(4)	Frequency
<input type="text"/>	000000	MAIN	450.3250
<input type="text"/>	<input type="text"/>	<input type="text"/>	<input type="text"/>
<input type="text"/>	<input type="text"/>	<input type="text"/>	<input type="text"/>
<input type="text"/>	<input type="text"/>	<input type="text"/>	<input type="text"/>
<input type="text"/>	<input type="text"/>	<input type="text"/>	<input type="text"/>
<input type="text"/>	<input type="text"/>	<input type="text"/>	<input type="text"/>
<input type="text"/>	<input type="text"/>	<input type="text"/>	<input type="text"/>

SAVE DEL

INDIVIDUAL SET

INDIVIDUAL ID-CHANGE: >>>

ICON-LIST ALL DELETE: RESET

GROUP CALL: G-CALL

GROUP SLEEP: G-SLEEP

LOG CLEAR: CLEAR

GENI LOG

Log Search and Save

```
> 16:23:29-Pager : 0006 / Corner : 00 / Status : WAIT
> 16:23:23-Pager : 0020 / Corner : 00 / Status : SEAT
> 16:23:20-Pager : 0001 / Corner : 00 / Status : WAIT
> 16:23:16-Pager : 0013 / Corner : 00 / Status : SEAT
> 16:23:13-Pager : 0017 / Corner : 00 / Status : SEAT
> 16:23:10-Pager : 0011 / Corner : 00 / Status : SEAT
> 16:23:10-Pager : 0003 / Corner : 00 / Status : SEAT
> 16:23:00-Pager : 0017 / Corner : 00 / Status : WAIT
> 16:23:00-Pager : 0011 / Corner : 00 / Status : WAIT
> 16:23:00-Pager : 0003 / Corner : 00 / Status : WAIT
> 16:23:00-Pager : 0013 / Corner : 00 / Status : WAIT
```

2013 | LEE TECHNOLOGY KOREA CO.,LTD. ALL RIGHTS RESERVED
TEL | +82.32.324.9838 FAX | +82.32.324.9840
Leetek Building, 47, Ojeong-ro, Bucheon-si, Gyeonggi-do, KOREA

LEETEK | Geni Finder Server System.

Table Location Map

The screenshot displays the LEETEK Geni Finder Client 6.3 interface. The main window is titled "MAP SET" and features a dark blue grid background. Several numbered table icons (1-7) are placed on the grid, each accompanied by a blue person icon and a small orange 'x' icon. A "kitchen" icon and a "counter" icon are also visible on the grid. The interface includes a top navigation bar with "ICON SET / MAP SET" and a "SERVER IP ADDRESS" field set to "127.0.0.1". A "CONNECT" button and a "Call" dropdown menu are also present. A "SEND" button and a "SET CONFIG" button are located in the top right corner. A "GUID" icon is visible in the top right corner of the main window. The bottom of the window features a toolbar with icons for "table", "counter", "kitchen", and "clear", along with a "SAVE" button. The left sidebar shows a list of items, including "13" and "1", with associated "WAIT" and "TABLE" labels. The right sidebar shows a list of items, including "TABLE - 008" and "TABLE - 009:51", with associated "MAP" labels. The top left corner of the window shows the title "LEETEK - Geni Finder Client 6.3" and the date and time "02-13-2018 16:33:04".

EasyVu Guest Tag Customisation

Guest Tag

- The guest tag for EasyVu will come with the CST decal that's created internally
- The CST decal will say EasyVu Guest Locator
- The diameter is 75mm round
- We will use our standard process of shipping the guest tags with our CST decal
- Customized guest tag decals can be purchased at extra cost
- The artwork should be in a JPEG or Adobe file
- Pre-printed / branded decals will need to meet all requirements

EasyVu Table Tag Customisation

Table Tag

- The table tag for EasyVu will come with the standard artwork created by CST
- The table tag is a durable-plastic adhesive card
- The dimensions for the table tag are 54 mm x 85 mm
- Our process will be to ship standard table tags with each sales order
- Customized table tags can be purchased extra for £2 each
- The artwork should be in a JPEG or Adobe file
- There will be 50 minimum quantity orders
- The lead time for customized table tags will be up to 3 weeks



Call Systems Technology Ltd.
Unit 240 Centennial Park, Elstree, WD6 3SJ

T: +44 (0) 20 8381 1338 • E: solutions@call-systems.com W: www.call-systems.com